

Eshteal Arak Industrial Engineering Company is the only manufacturer of high-capacity rotary cup burners in the country, and these burners are used by all boiler companies in the country. Among the unique products produced by this company are power valves that are designed for saturated and superheated steam lines. This product was produced for the first time in the country in 2014 in the Mobarake steel complex and at a pressure of 70 bar. It has been used successfully. Eshteal Arak Industrial Engineering Company has been modernizing its production lines since 2003 and is currently equipped with more than 98 machines, 61 of which are CNC lathes and milling centers (referred to at the end), stepped into the field of producing products with modern sophisticated technology. It should be mentioned that this company has succeeded in obtaining the knowledge-based badge on burners and valves during two consecutive periods, and in order to enhance the brand and satisfy customers, the necessary standards such as ISIRI 7595, ISIRI 7594, ISO 3834, ISO 9001:2015 and implemented 5S

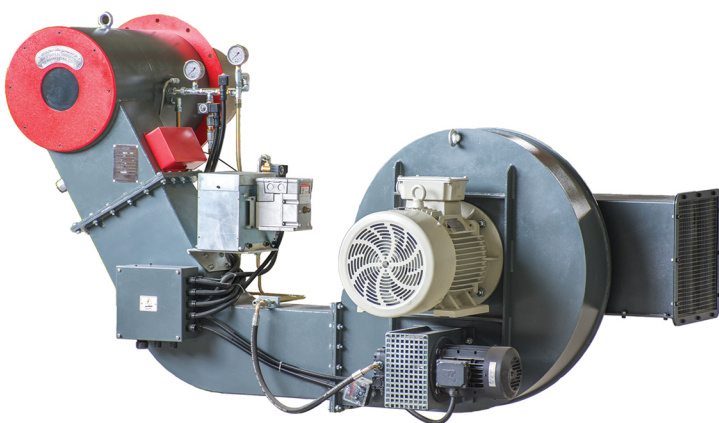

The ECB series covers a firing range from 3.6 MW through to 31 MW, and have been designed for use on hot water or industrial steam Boilers.

ECB Series Burner



ESHTEAL ARAK

INDUSTRIAL ENGINEERING CO.
Manufacturer of burners, valves
and precision tools for steam boilers

☎ 5
☎ 09908136277 (sales)
☎ 09912709038 (after sales)
☎ 34131217
✉ eshteal.arak@gmail.com
✉ eshteal.commerce@gmail.com
📷 eshtealarak

📍 Factory: Hadid St-Haji Abad Industrial Zone 7th km of Qom Road-Arak-Iran
📍 Head office: 4th floor-No.3 Apartment Asef Vaziri alley southern Bahar St Taleghani St-Tehran-Iran

ECB SERIES BURNER

RANGE OVERVIEW

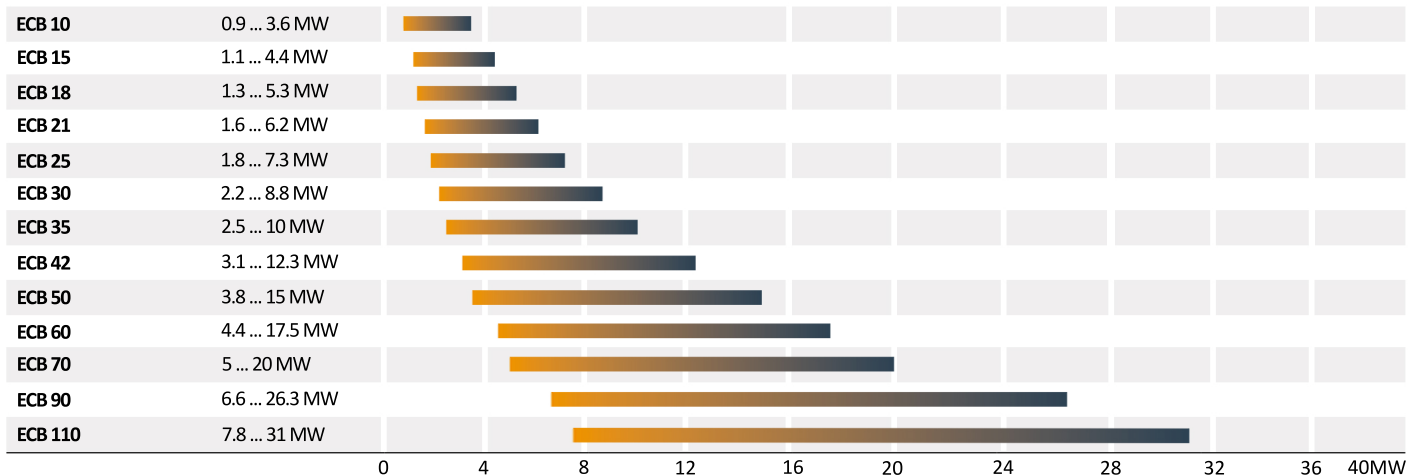

MAIN FEATURES

- Large rear flame viewing port, enabling a unique view of the combustion process .
- Simple construction allows easy access to internal components for maintenance.
- Multiple fixings on the burner rear section allows fan to be mounted in a variety of different positions to overcome site space restraints.
- Stainless steel diffusers and blast tube cones.
- Designed in accordance with the European Standard EN 676 and EN267 and approved in accordance with the Iranian Standard ISIRI 7594 and ISIRI 7595.
- turndown of 4:1.
- Version with fully electronic Burner Management System available (LAMTEC combustion management system).
- Emission class: Low NOx class 2 (≤ 120 mg/kWh).
- Suitable for gas (LPG, NG) and oil (Light oil, Heavy oil).

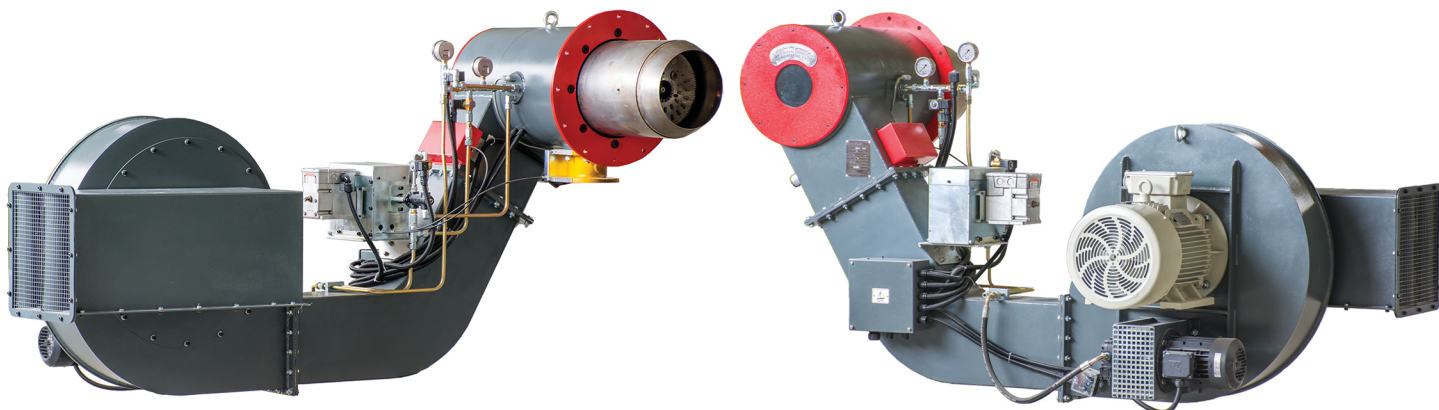

Dimensions (approx .) in mm

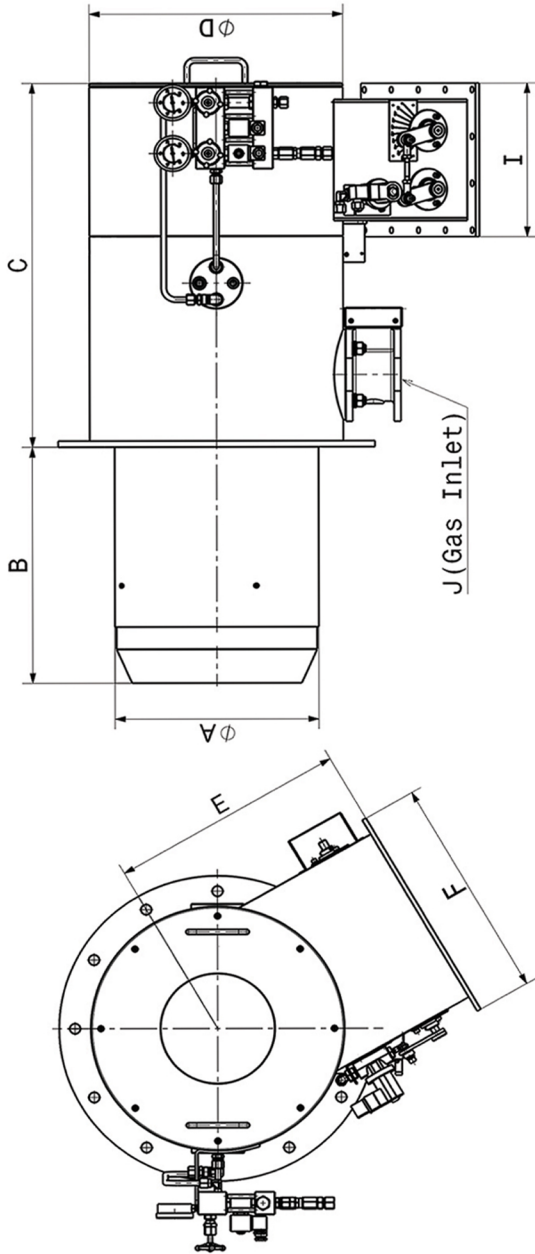

BURNER MODEL	A	B	C	D	E	F	I	J
ECB-M 10	305	396	653	395	411	376	276	2 1/2"
ECB-M 15	316	396	653	395	411	376	276	2 1/2"
ECB-M 18	370	431	715	480	450	434	302	3"
ECB-M 21	386	464	715	480	450	434	302	3"
ECB-M 25	425	556	830	630	560	575	420	4"
ECB-M 30	455	575	830	630	560	575	420	4"
ECB-M 35	500	595	830	630	560	575	420	4"
ECB-M 42	550	726	1220	835	663	730	603	6"
ECB-M 50	590	768	1220	395	663	730	603	6"
ECB-M 60	645	783	1220	835	663	730	603	6"
ECB-M 70	700	809	1220	835	663	730	603	6"
ECB-M 90	785	986	1623	1055	835	905	702	8"
ECB-M 110	880	1035	1623	1055	835	905	702	8"